

Indicative Planting Schedule:

**Trees:**  
All trees bare root (containerised if bare root not available), feathered, and 2x age to be planted as shown on plan.

<i>Alnus glutinosa</i> , Alder, 175-200cm	25%
<i>Betula pubescens</i> , Downy Birch, 200-250cm	20%
<i>Salix caprea</i> , Goats Willow, 175-200cm	15%
<i>Salix pentandra</i> , Bay Willow, 175-200cm	25%
<i>Sorbus aucuparia</i> , Rowan, 175-200cm	15%

Seed Mixes

The final seed mixes will be chosen to best suit the soil and site conditions and to be approved by an ecologist.

Species Rich Grassland Mix:

Sow rate of 20kg per ha with 80% grass and 20% wildflower ratio. Wildflowers to be supplied by 'Design by Nature' or other as approved.

To consist of the following species mix:

<i>Agrostis capillaris</i> , Common Bent	4%
<i>Festuca rubra</i> , Red Fescue	35%
<i>Poa pratensis</i> , Smooth Stalked Meadow Grass	15%
<i>Cynosurus cristatus</i> , Crested Dog's Tail	4%
<i>Festuca ovina</i> , Sheep's Fescue	27%
<i>Poa trivialis</i> , Rough Stalked Meadow Grass	15%

Wild Bird Seed Mix:

Sow rate of 20kg per hectare, to be supplied by Watson Seeds, or similar approved.

<i>Sinapis arvensis</i> , Mustard	12%
<i>Raphanus sativus</i> , Fodder Radish	10%
<i>Avena sativa</i> , Oats	70%
<i>Chenopodium quinoa</i> , Quinoa	8%

Outline Landscape Specifications:

Existing Vegetation:

Any necessary works being undertaken within close proximity and to the retained tree lined hedgerows should be carried out in accordance with BS 3998:2010 Tree work Recommendations, BS 5857:2012 Trees in Relation to Design Demolition and Construction and NJUG 4 Guidelines for the Planning, Installation and Maintenance of Utility Apparatus in Proximity to Trees and in consultation with an arborist.

Proposed Planting:

Planting to be supplied in accordance with BS 3936-1:1992 Nursery Stock, specification for trees and shrubs, BS 3936-4:2007 Nursery Stock, specification for forest trees, poplars and willows, BS 8545:2014 Trees from nursery to independence in the landscape. All landscaping works to be in accordance with BS4428:1989 "General Landscaping Works." All planting should be source from local provenance certified seed stock where possible with other sources needing to be approved.

Feathered Tree Planting

Feathered trees to be planted into prepared pits of topsoil 500x500x450mm deep. It is assumed that topsoil is present on site however this may need to be supplemented with imported material if soil is not available to the depth required. Any compacted material at the base of the pit to be forked a further 200mm to provide demonstrable free drainage. Backfill to consist of site excavated topsoil with 25% Treestart Peat-Free planting compost incorporated. Sierrablend Flora Tablets slow release fertiliser incorporated into the tree pit at a rate of 5 tablets per tree, placed at the side of the root zone halfway up the backfill, no deeper than 20cm and distributed evenly around the roots. Trees to be secured by a single rubber tree tie with spacer to one 40mm dia. turned larch tree stake 1200mm long driven 600mm into the ground. Stakes to be once weathered at 45degrees.

Hedgerow Planting:

Hedge beds shall be excavated to a width of 700mm wide and 300mm deep, with sides and base aerated. Short lengths of individual whip infilling may be undertaken by notch planting. The existing soil should be improved by digging in well rotten Farm Yard Manure or other soil improver. Hedging plants/whips shall be healthy, vigorous, bushy and well rooted and not less than 400mm high. Whips shall be laid at 7 plants per linear metre, randomly mixed in double standard rows 300mm apart. For infill hedgerow planting the whips shall be laid at 5 plants per metre, randomly mixed in double standard rows 400mm apart. Whips to be planted at the depth previously grown, with roots carefully spread and packed with finely broken soil, well consolidated and firmly heeled around the plant collar. After planting, hedges shall be watered thoroughly as required. All hedging to be supported by a clear spiral rabbit guard 600mm high 38mm dia. supported by a bamboo cane and 1m wide mulch matting on completion of planting.

Species Rich Grassland Mix Seeding:

Clear area of weeds, apply pre-seeding granular fertiliser to tilth at a rate of 70g/m² and lightly rake in. Apply seed mix (as above) to the soil surface, gently firmed in by rolling. Area to be watered on completion. The disturbed areas of grassland will be sown with a low growing species rich mix of grasses, which will be lightly grazed by sheep or maintained by cutting.

Wildflower Seed Mix & Wild Bird Seed Mix Seeding

The areas of wildflower and bird seed mixes will be separated from the surrounding grassland by a stock-proof fencing to prevent any possible grazing by animals. Wildflower Seed Mix shall be sown in September or March/April, after the completion of the construction phase. Clear area of weeds, apply seed mix (sowing rate as above) to the soil surface, gently firmed in by rolling. Wild Bird Seed Mix is to be sown annually in March/April, after the completion of the construction phase. Area to be ploughed and harrowed to a fine tilth and sow the mix (sowing rate as above).

Timing & Aftercare (5yr landscape maintenance plan):

Planting of the hedgerow and trees to take place during the months of November to March, preferably before January and at a time when the soil is not frozen or waterlogged. The new plants will be watered in at the time of planting and regularly during their first year. All tree and hedgerow species will have a minimum 1m wide radius free of any weeds until 3 years after planting, when they are well established. Weeding will be done using a mulch mat and either by hand or mechanical control as required in order to prevent competition for nutrients from weeds and grasses. The planting supports and guards will be inspected regularly to ensure they are not impeding the plant's growth and will be adjusted or replaced as required. These will be removed when the planting is established within the initial 3 years.

The new hedgerow planting will be reduced by a third in height immediately after planting hawthorn and blackthorn, with other species lightly pruned and cut later in the first autumn. Trim in January/February to avoid the bird nesting season (March to August) and to allow berry crop to be available for by wintering birds (September - December). Trim on a two- or three- year rotation and shaped to an 'A' shape, to ensure thick nesting cover is available and increases the berry crop and populations of over-wintering insects. The hedging will be cut on a rotational basis using mechanical methods approximately every 2-3 years and shaped to an 'A' shape.

The grassland will be managed by light grazing or cutting several times in the first year to reduce competition from annual weeds and allow the grass to become established. Weeds may also need treating through spot treatment with an appropriate approved herbicide. In the second year and onwards the grassland can be maintained by a light grazing regime through the year or by cutting.

Areas of wildflower mix will similarly need controlling of any initial flushes of weeds and persistent weeds. In the first year cut twice (first cut in August/September; second cut in October) maintaining a vegetation height of 100-150mm, remove arisings from site. In the second year and thereafter, cut once a year in August/September to a height of 50mm after the plants have flowered, with the cut growth allowed to sit for a few days to release any seeds prior to removing arisings from site.

Areas of Wild Bird Seed Mix shall be left to grow through the summer and left un-harvested through the winter.

Any loss of planting which occurs within 5 years of the initial planting as a result of plant failure will be replaced with the same plant species. Final location and number of bird nest boxes, bat boxes hibernacula and bee/beetle banks to be determined on site by an ecologist.

Avoiding physical damage to the roots during demolition or construction

To avoid damage to the roots, existing ground levels should be retained within 1.5m perimeter of the outer perimeter of the hedge. Intrusion into the soil within this area is generally not acceptable, and topsoil within it should be retained in situ.

Hedgerow Mix:

Planted up behind or through gaps in the site's exterior boundaries. Planted as double staggered rows at 6-8 per metre and spacings of 300-400mm as indicated in the key.

<i>Corylus avellana</i> , Hazel, 1 +1 40-60cm BR	10%
<i>Crataegus monogyna</i> , Hawthorn, 1+1 40-60cm BR	55%
<i>Ilex aquifolium</i> , Holly 60-90cm C	10%
<i>Prunus padus</i> , Bird Cherry 1+1 40-60cm BR	5%
<i>Prunus spinosa</i> , Blackthorn, 1+1 40-60cm BR	5%
<i>Rosa canina</i> , Dog Rose, 1+1 40-60cm BR	5%
<i>Viburnum opulus</i> , Guelder Rose, 1+1 40-60cm BR	5%
<i>Ulex europaeus</i> , Gorse, 1+1 60-90cm 2L CG	5%

Wildflower Mix:

Sow rate of 40kg per ha with 80% grass and 20% wildflower ratio. Wildflowers to be supplied by 'Design by Nature' or other as approved.

<i>Lotus corniculatus</i> , Birds Foot Trefoil	8%
<i>Centaurea nigra</i> , Black Knapweed	5%
<i>Medicago lupulina</i> , Black Medick	3%
<i>Vicia sativa</i> , Common Vetch	4%
<i>Galium verum</i> , Lady's Bedstraw	2%
<i>Lathyrus pratensis</i> , Meadow Vetchling	3%
<i>Ranunculus acris</i> , Meadow Buttercup	3%
<i>Malva moschata</i> , Musk Mallow	2%
<i>Leucanthemum vulgare</i> , Ox-eye Daisy	8%
<i>Silene dioica/latifolia</i> , Red/White Campion	2%
<i>Trifolium repens</i> , Red Clover	10%
<i>Prunella vulgaris</i> , Selfheal	5%
<i>Onobrychis vicifolia</i> , Sainfoin	36%
<i>Achillea millefolium</i> , Yarrow	6%
<i>Rhinanthus minor</i> , Yellow Rattle	3%

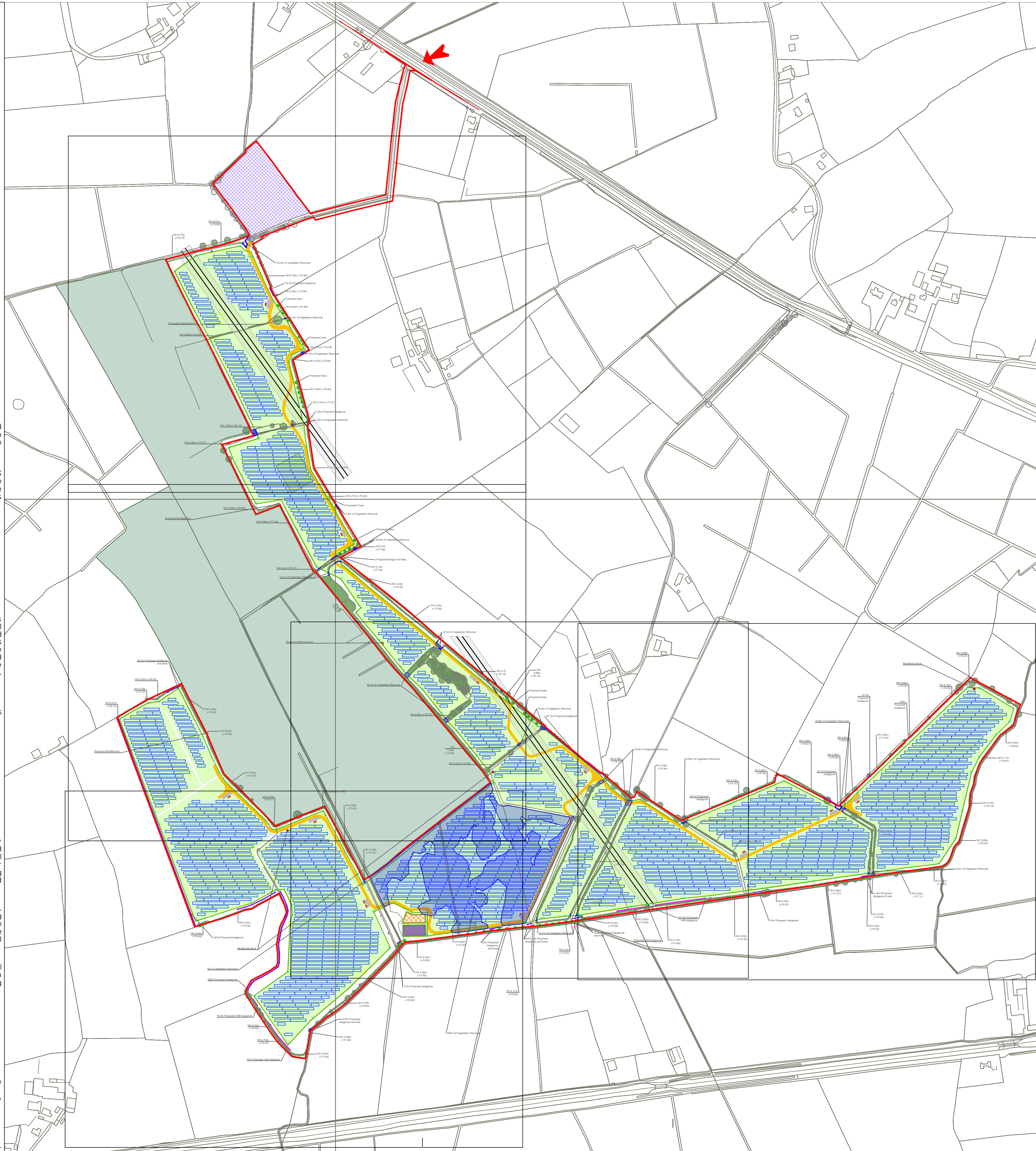

Key

Landscaping & Ecology Measures

- Indicative Existing Conifer Plantation
- Indicative Existing Hedgerow & Trees to be retained
- Existing Hedgerow Heights (m) with height AOD
- Indicative Hedgerow (535.66m)&Scrub removed
- Proposed Trees (54)
- Proposed New Hedgerow Planting (246.7m)
- Proposed Infill Hedgerow Planting (1,113m)
- Proposed Species Rich Grassland Mix
- Proposed Species Rich Grassland and Wildflower Mix
- Proposed Bird Seed Mix
- Proposed Bee/Beetle Bank (3)
- Proposed Hibernaculum (2)
- Proposed Bird & Bat Boxes (2)

SITE BOUNDARY  
(OUTSIDE EDGE OF LINE DENOTES BOUNDARY)

PERIMETER DEER FENCE

GATE

PROPOSED INTERNAL TRACK

INDICATIVE SOLAR PV ARRAY

TRANSFORMER AREAS

HARDSTAND

TEMPORARY CONSTRUCTION COMPOUND

CCTV

ALL CONSENTED INFRASTRUCTURE  
(ref: 2198) TO BE REMOVED

OVERHEAD LINE WAYLEAVE

SITE ENTRANCE

CONSENTED INFRASTRUCTURE (ref: 2198)

EXISTING TRACK

PROPOSED INTERNAL TRACK

SITE ENTRANCE - VISIBILITY SPY

Notes:

Plan to be read in conjunction with the Site Layout drawing no. 04386-RES-LAY-DR-PT-201  
Site Entrance drawing no. 04386-RES-ACC-DR-PE-002 of boundary amendments along site entrance.  
© Neo Environmental Limited unless otherwise stated.  
Do not scale from drawings, use dimensioned figures only.  
Planning Issue only not for construction.  
Ordinance Survey Ireland Licence No. EN 0085320  
© Ordnance Survey Ireland/Government of Ireland

Ver.	Date	Comments
H	20/11/2025	Updated design for Amendment Application
G	04/11/2025	Updated layout for Amendment Application
F	23/10/2025	Updated layout for Amendment Application
E	15/10/2025	Updated layout for Amendment Application
D	20/11/2024	Updated layout for Amendment Application
C	04/10/2021	Adjusted hedge height text size, clarified location of proposed planting
B	14/07/2020	Added existing hedgerow heights, amended proposed hedge graphics, altered location of wild bird seed mix.
A	26/10/2020	



Nass Office: T:00353 (0)45 844250 E: info@neo-environmental.ie  
Glasgow Office: T: 0141 773 6262 E: info@neo-environmental.co.uk  
Warwickshire Office: T:01768 297012 E: info@neo-environmental.co.uk  
Ballymena Office: T:02890517092 E: info@neo-environmental.co.uk

Project:	Ballyteige Solar Farm
Client:	RES
Drawing:	Landscape & Ecology Management Plan
Project No.:	NEO00687 Figure 1.11a
Drawing No.:	NEO00687_028_A
Drawn:	GC/DW/TL
Checked:	KB
Approved:	PN
Scale:	1:4,000 @ A1
Date:	28th January 2026
Revision:	H



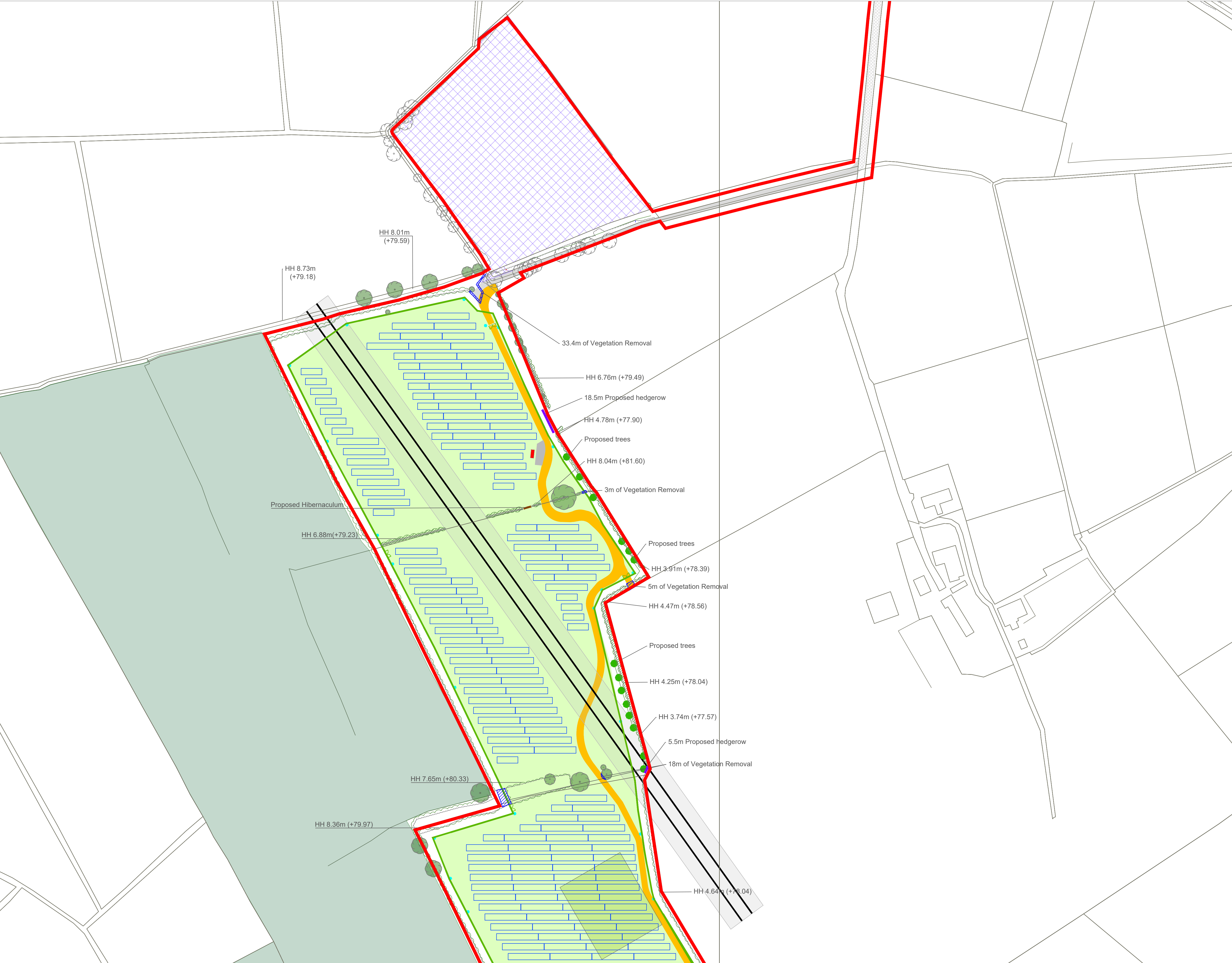

- Key**
- Landscaping & Ecology Measures**
- Indicative Existing Conifer Plantation
  - Indicative Existing Hedgerow & Trees to be retained
  - Existing Hedgerow Heights (m) with height AOD
  - Indicative Hedgerow (535.66m)&Scrub removed
  - Proposed Trees (54)
  - Proposed New Hedgerow Planting (246.7m)
  - Proposed Infill Hedgerow Planting (1,113m)
  - Proposed Species Rich Grassland Mix
  - Proposed Species Rich Grassland and Wildflower Mix
  - Proposed Bird Seed Mix
  - Proposed Bee/Beetle Bank (3)
  - Proposed Hibernaculum (2)
  - Proposed Bird & Bat Boxes (2)

- SITE BOUNDARY (OUTSIDE EDGE OF LINE DENOTES BOUNDARY)
- PERIMETER DEER FENCE
- GATE
- PROPOSED INTERNAL TRACK
- INDICATIVE SOLAR PV ARRAY
- TRANSFORMER AREAS
- HARDSTAND
- TEMPORARY CONSTRUCTION COMPOUND
- CCTV
- ALL CONSENTED INFRASTRUCTURE (ref: 2198) TO BE REMOVED
- OVERHEAD LINE WAYLEAVE
- SITE ENTRANCE
- CONSENTED INFRASTRUCTURE (ref: 2198)
- EXISTING TRACK
- PROPOSED INTERNAL TRACK
- SITE ENTRANCE - VISIBILITY SPLAY

**Notes:**

Plan to be read in conjunction with the Site Layout drawing no. 04386-RES-LAY-DR-PT-201  
Site Entrance drawing no. 04386-RES-ACC-DR-PE-002 of boundary amendments along site entrance.

© Neo Environmental Limited unless otherwise stated.  
Do not scale from drawing: use dimensioned figures only.  
Planning Issue only not for construction.  
Ordnance Survey Ireland Licence No. EN 0085320  
© Ordnance Survey Ireland/Government of Ireland

H	20/11/2025	Updated design for Amendment Application
G	04/11/2025	Updated layout for Amendment Application
F	23/10/2025	Updated layout for Amendment Application
E	15/10/2025	Updated layout for Amendment Application
D	20/11/2024	Updated layout for Amendment Application
C	04/10/2021	Adjusted hedge height text size, clarified location of proposed planting
B	14/07/2020	Added existing hedgerow heights, amended proposed hedge graphics, altered location of wild bird seed mix.
A	26/10/2020	

**neo**  
**ENVIRONMENTAL**

Nass Office: T:00353 (0)45 844250 E: info@neo-environmental.ie  
Glasgow Office: T: 0141 773 6262 E: info@neo-environmental.co.uk  
Warwickshire Office: T:01768 297012 E: info@neo-environmental.co.uk  
Ballymena Office: T:02890517092 E: info@neo-environmental.co.uk

**Project:** Ballyteige Solar Farm  
**Client:** RES  
**Drawing:** Landscape & Ecology Management Plan  
**Project No.:** NEO00687 **Figure 1.11b**  
**Drawing No. :** NEO00687\_029\_B  
**Drawn:** GC/DW/TL **Checked:** KB **Approved:** PN  
**Scale:** 1:1,000 @ A1 **Revision:**  
**Date:** 28th January 2026 **H**



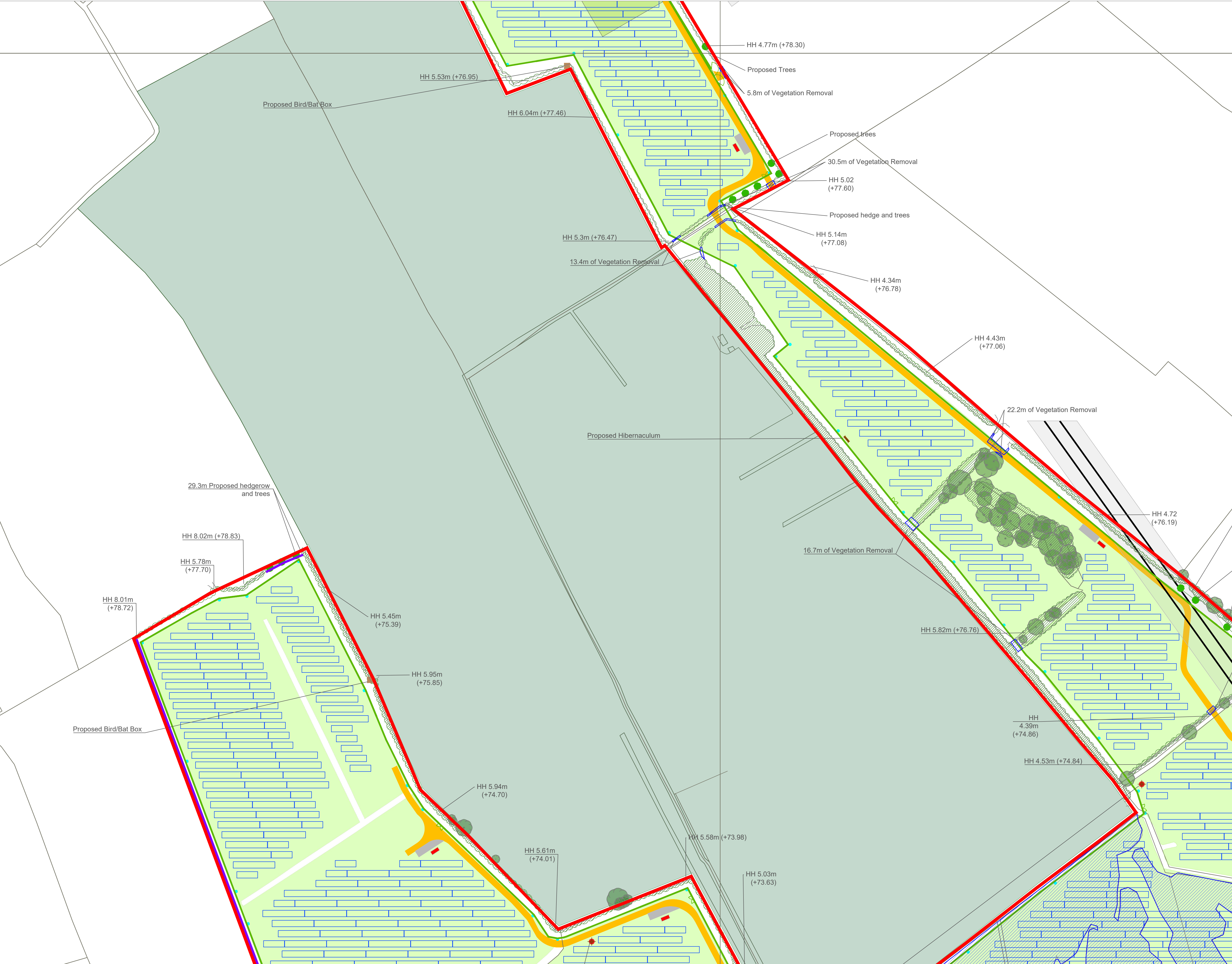

- Key**
- Landscaping & Ecology Measures**
- Indicative Existing Conifer Plantation
  - Indicative Existing Hedgerow & Trees to be retained
  - Existing Hedgerow Heights (m) with height AOD
  - Indicative Hedgerow (535.66m)&Scrub removed
  - Proposed Trees (54)
  - Proposed New Hedgerow Planting (246.7m)
  - Proposed Infill Hedgerow Planting (1,113m)
  - Proposed Species Rich Grassland Mix
  - Proposed Species Rich Grassland and Wildflower Mix
  - Proposed Bird Seed Mix
  - Proposed Bee/Beetle Bank (3)
  - Proposed Hibernaculum (2)
  - Proposed Bird & Bat Boxes (2)

- SITE BOUNDARY**  
(OUTSIDE EDGE OF LINE DENOTES BOUNDARY)
- PERIMETER DEER FENCE**
- GATE**
- PROPOSED INTERNAL TRACK**
- INDICATIVE SOLAR PV ARRAY**
- TRANSFORMER AREAS**
- HARDSTAND**
- TEMPORARY CONSTRUCTION COMPOUND**
- CCTV**
- ALL CONSENTED INFRASTRUCTURE (ref. 2198) TO BE REMOVED**
- OVERHEAD LINE WAYLEAVE**
- SITE ENTRANCE**
- CONSENTED INFRASTRUCTURE (ref. 2198)**
- EXISTING TRACK**
- PROPOSED INTERNAL TRACK**
- SITE ENTRANCE - VISIBILITY SPLAY**

**Notes:**

Plan to be read in conjunction with the Site Layout drawing no. 04386-RES-LAY-DR-PT-201  
Site Entrance drawing no. 04386-RES-ACC-DR-PE-002 of boundary amendments along site entrance.

© Neo Environmental Limited unless otherwise stated.  
Do not scale from drawing- use dimensioned figures only.  
Planning Issue only not for construction.  
Ordnance Survey Ireland Licence No. EN 0085320  
© Ordnance Survey Ireland/Government of Ireland

Ver.	Date	Comments
H	20/11/2025	Updated design for Amendment Application
G	04/11/2025	Updated layout for Amendment Application
F	23/10/2025	Updated layout for Amendment Application
E	15/10/2025	Updated layout for Amendment Application
D	20/11/2024	Updated layout for Amendment Application
C	04/10/2021	Adjusted hedge height text size, clarified location of proposed planting
B	14/07/2020	Added existing hedgerow heights, amended proposed hedge graphics, altered location of wild bird seed mix.
A	26/10/2020	

**neo ENVIRONMENTAL**

Naas Office: T:00353 (0)45 844250 E: info@neo-environmental.ie  
Glasgow Office: T: 0141 773 6262 E: info@neo-environmental.co.uk  
Warwickshire Office: T:01768 297012 E: info@neo-environmental.co.uk  
Ballymena Office: T:02890517092 E: info@neo-environmental.co.uk

**Project:** Ballyteige Solar Farm  
**Client:** RES  
**Drawing:** Landscape & Ecology Management Plan  
**Project No.:** NEO00687 **Figure 1.11c**  
**Drawing No. :** NEO00687\_030\_B  
**Drawn:** GC/DW/TL **Checked:** KB **Approved:** PN  
**Scale:** 1:1,000 @ A1 **Revision:**  
**Date:** 28th January 2026 **H**



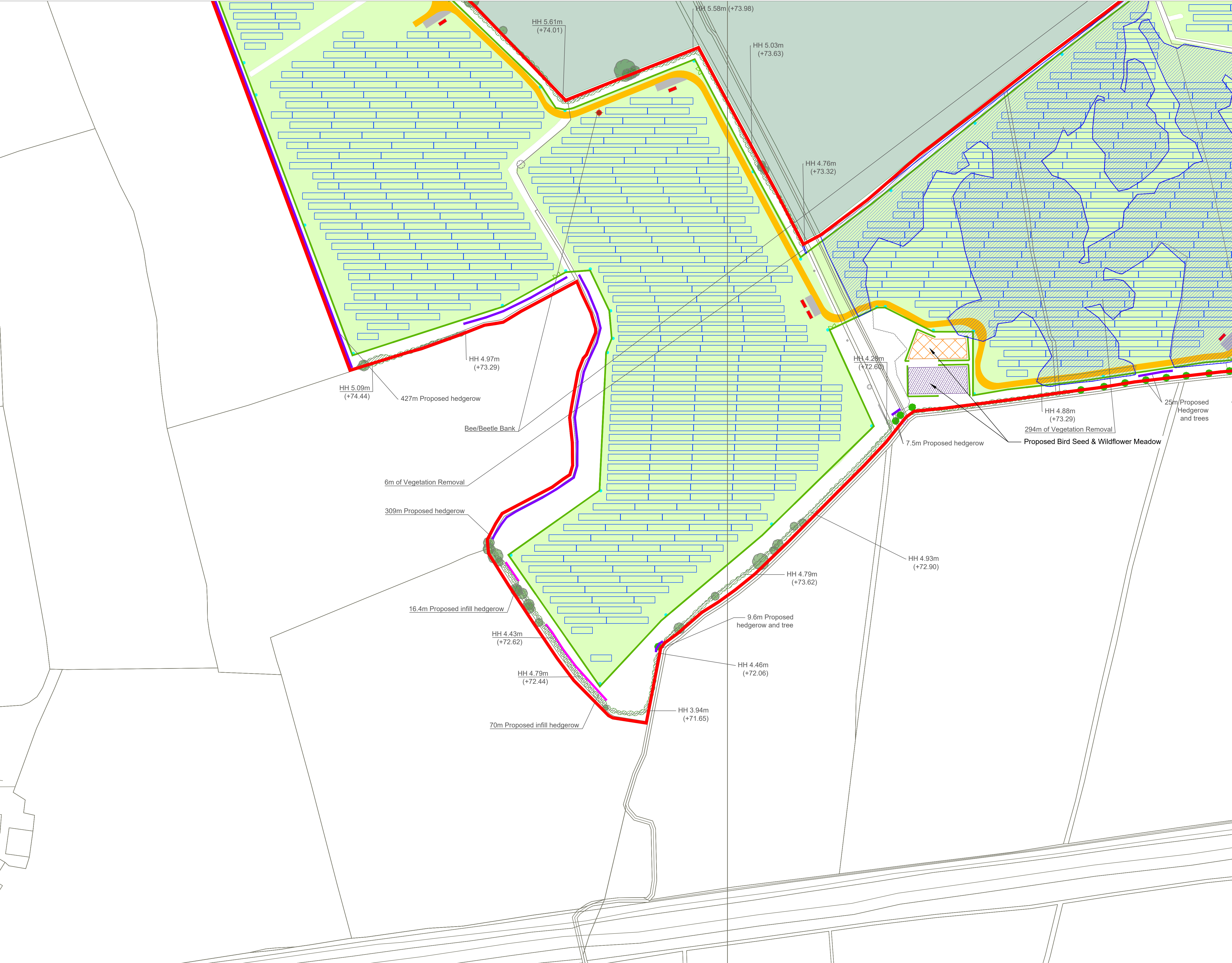

- Key**
- Landscaping & Ecology Measures**
- Indicative Existing Conifer Plantation
  - Indicative Existing Hedgerow & Trees to be retained
  - Existing Hedgerow Heights (m) with height AOD
  - Indicative Hedgerow (535.66m)&Scrub removed
  - Proposed Trees (54)
  - Proposed New Hedgerow Planting (246.7m)
  - Proposed Infill Hedgerow Planting (1,113m)
  - Proposed Species Rich Grassland Mix
  - Proposed Species Rich Grassland and Wildflower Mix
  - Proposed Bird Seed Mix
  - Proposed Bee/Beetle Bank (3)
  - Proposed Hibernaculum (2)
  - Proposed Bird & Bat Boxes (2)

- SITE BOUNDARY (OUTSIDE EDGE OF LINE DENOTES BOUNDARY)
- PERIMETER DEER FENCE
- GATE
- PROPOSED INTERNAL TRACK
- INDICATIVE SOLAR PV ARRAY
- TRANSFORMER AREAS
- HARDSTAND
- TEMPORARY CONSTRUCTION COMPOUND
- CCTV
- ALL CONSENTED INFRASTRUCTURE (ref. 2198) TO BE REMOVED
- OVERHEAD LINE WAYLEAVE
- SITE ENTRANCE
- CONSENTED INFRASTRUCTURE (ref. 2198)
  - EXISTING TRACK
  - PROPOSED INTERNAL TRACK
  - SITE ENTRANCE - VISIBILITY SPLAY

**Notes:**

Plan to be read in conjunction with the Site Layout drawing no. 04386-RES-LAY-DR-PT-201  
Site Entrance drawing no. 04386-RES-ACC-DR-PE-002 of boundary amendments along site entrance.

© Neo Environmental Limited unless otherwise stated.  
Do not scale from drawing- use dimensioned figures only.  
Planning Issue only not for construction.  
Ordnance Survey Ireland Licence No. EN 0085320  
© Ordnance Survey Ireland/Government of Ireland

Ver.	Date	Comments
H	20/11/2025	Updated design for Amendment Application
G	04/11/2025	Updated layout for Amendment Application
F	23/10/2025	Updated layout for Amendment Application
E	15/10/2025	Updated layout for Amendment Application
D	20/11/2024	Updated layout for Amendment Application
C	04/10/2021	Adjusted hedge height text size, clarified location of proposed planting
B	14/07/2020	Added existing hedgerow heights, amended proposed hedge graphics, altered location of wild bird seed mix.
A	26/10/2020	

**neo**  
**ENVIRONMENTAL**

Nass Office: T:00353 (0)45 844250 E: info@neo-environmental.ie  
Glasgow Office: T: 0141 773 6262 E: info@neo-environmental.co.uk  
Warwickshire Office: T:01768 297012 E: info@neo-environmental.co.uk  
Ballymena Office: T:02890517092 E: info@neo-environmental.co.uk

**Project:** Ballyteige Solar Farm  
**Client:** RES  
**Drawing:** Landscape & Ecology Management Plan  
**Project No.:** NEO00687 Figure 1.11d  
**Drawing No. :** NEO00687\_031\_B  
**Drawn:** GC/DW/TL**Checked:**KB**Approved:** PN  
**Scale:** 1:1000 @ A1 **Revision:**  
**Date:** 28th January 2026 **H**



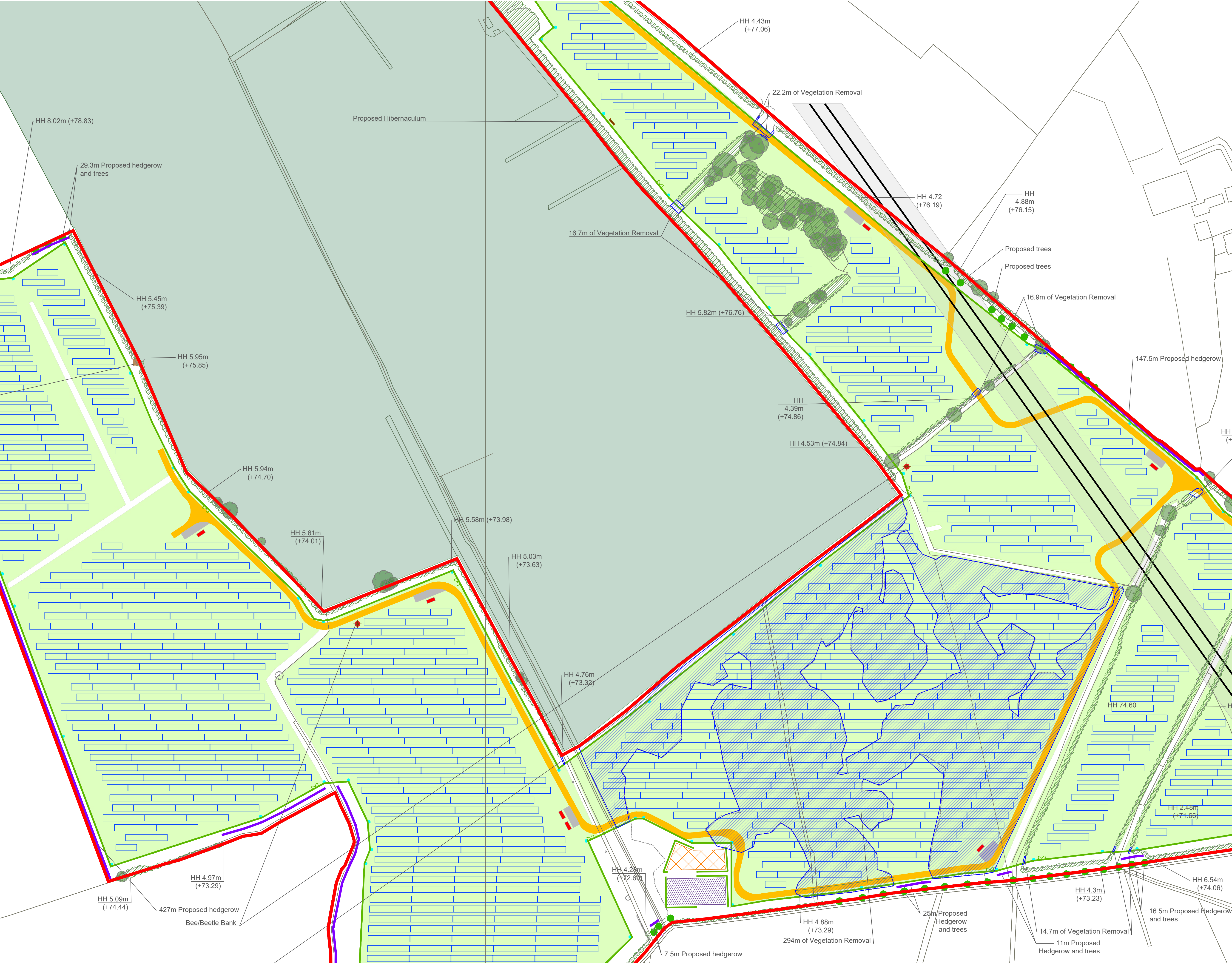

- Key
- Landscaping & Ecology Measures
- Indicative Existing Conifer Plantation
  - Indicative Existing Hedgerow & Trees to be retained
  - Existing Hedgerow Heights (m) with height AOD
  - Indicative Hedgerow (535.66m)&Scrub removed
  - Proposed Trees (54)
  - Proposed New Hedgerow Planting (246.7m)
  - Proposed Infill Hedgerow Planting (1,113m)
  - Proposed Species Rich Grassland Mix
  - Proposed Species Rich Grassland and Wildflower Mix
  - Proposed Bird Seed Mix
  - Proposed Bee/Beetle Bank (3)
  - Proposed Hibernaculum (2)
  - Proposed Bird & Bat Boxes (2)

- SITE BOUNDARY (OUTSIDE EDGE OF LINE DENOTES BOUNDARY)
- PERIMETER DEER FENCE
- GATE
- PROPOSED INTERNAL TRACK
- INDICATIVE SOLAR PV ARRAY
- TRANSFORMER AREAS
- HARDSTAND
- TEMPORARY CONSTRUCTION COMPOUND
- CCTV
- ALL CONSENTED INFRASTRUCTURE (ref: 2198) TO BE REMOVED
- OVERHEAD LINE WAYLEAVE
- SITE ENTRANCE
- CONSENTED INFRASTRUCTURE (ref: 2198)
- EXISTING TRACK
- PROPOSED INTERNAL TRACK
- SITE ENTRANCE - VISIBILITY SPLAY

Notes:

Plan to be read in conjunction with the Site Layout drawing no. 04386-RES-LAY-DR-PT-201

Site Entrance drawing no. 04386-RES-ACC-DR-PE-002 of boundary amendments along site entrance.

© Neo Environmental Limited unless otherwise stated.  
Do not scale from drawing- use dimensioned figures only.  
Planning Issue only not for construction.  
Ordnance Survey Ireland Licence No. EN 0085320  
© Ordnance Survey Ireland/Government of Ireland

Ver.	Date	Comments
H	20/11/2025	Updated design for Amendment Application
G	04/11/2025	Updated layout for Amendment Application
F	23/10/2025	Updated layout for Amendment Application
E	15/10/2025	Updated layout for Amendment Application
D	20/11/2024	Updated layout for Amendment Application
C	04/10/2021	Adjusted hedge height text size, clarified location of proposed planting
B	14/07/2020	Added existing hedgerow heights, amended proposed hedge graphics, altered location of wild bird seed mix.
A	26/10/2020	

neoENVIRONMENTAL

Near Office: T:00353 (0)45 844250 E: info@neo-environmental.ie

Glasgow Office: T: 0141 773 6262 E: info@neo-environmental.co.uk

Warwickshire Office: T:01768 297012 E: info@neo-environmental.co.uk

Ballymena Office: T:02890517092 E: info@neo-environmental.co.uk

Project: Ballyteige Solar Farm

Client: RES

Drawing: Landscape & Ecology Management Plan

Project No.: NEO00687 Figure 1.11e

Drawing No. : NEO00687\_032\_B

Drawn: GC/DW/TLChecked:KB Approved: PN

Scale: 1:1000 @ A1 Revision: H

Date: 28th January 2026



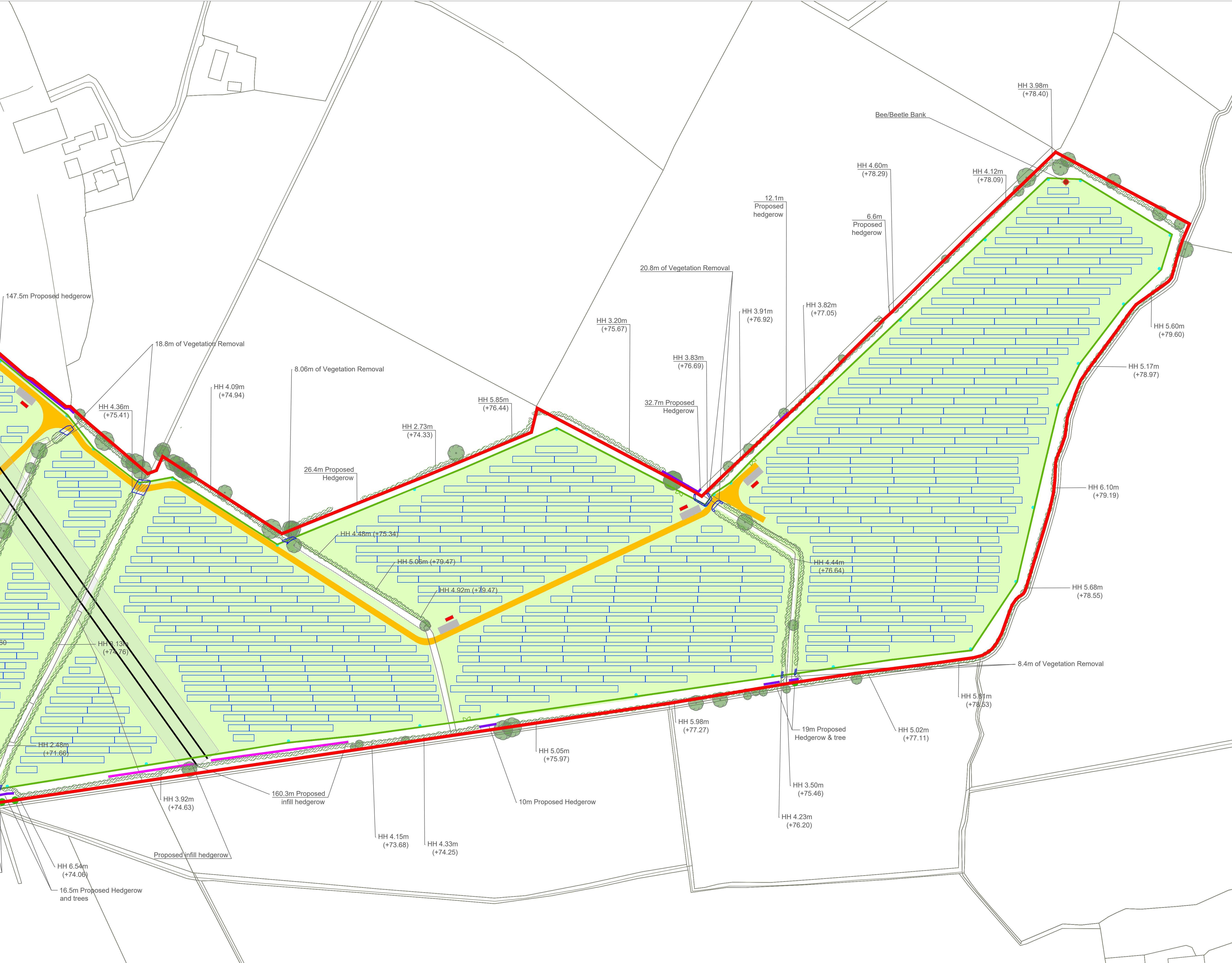

- Key**
- Landscaping & Ecology Measures**
- Indicative Existing Conifer Plantation
  - Indicative Existing Hedgerow & Trees to be retained
  - Existing Hedgerow Heights (m) with height AOD
  - Indicative Hedgerow (535.66m) & Scrub removed
  - Proposed Trees (54)
  - Proposed New Hedgerow Planting (246.7m)
  - Proposed Infill Hedgerow Planting (1,113m)
  - Proposed Species Rich Grassland Mix
  - Proposed Species Rich Grassland and Wildflower Mix
  - Proposed Bird Seed Mix
  - Proposed Bee/Beetle Bank (3)
  - Proposed Hibernaculum (2)
  - Proposed Bird & Bat Boxes (2)

- SITE BOUNDARY (OUTSIDE EDGE OF LINE DENOTES BOUNDARY)
- PERIMETER DEER FENCE
- GATE
- PROPOSED INTERNAL TRACK
- INDICATIVE SOLAR PV ARRAY
- TRANSFORMER AREAS
- HARDSTAND
- TEMPORARY CONSTRUCTION COMPOUND
- CCTV
- ALL CONSENTED INFRASTRUCTURE (ref: 2198) TO BE REMOVED
- OVERHEAD LINE WAYLEAVE
- SITE ENTRANCE
- CONSENTED INFRASTRUCTURE (ref: 2198)
- EXISTING TRACK
- PROPOSED INTERNAL TRACK
- SITE ENTRANCE - VISIBILITY SPLAY

**Notes:**

Plan to be read in conjunction with the Site Layout drawing no. 04386-RES-LAY-DR-PT-201  
Site Entrance drawing no. 04386-RES-ACC-DR-PE-002 of boundary amendments along site entrance.

© Neo Environmental Limited unless otherwise stated.  
Do not scale from drawing- use dimensioned figures only.  
Planning Issue only not for construction.  
Ordnance Survey Ireland Licence No. EN 0085320  
© Ordnance Survey Ireland/Government of Ireland

Ver	Date	Comments
G	04/11/2025	Updated layout for Amendment Application
F	23/10/2025	Updated layout for Amendment Application
E	15/10/2025	Updated layout for Amendment Application
D	20/11/2024	Updated layout for Amendment Application
C	04/10/2021	Adjusted hedge height text size, clarified location of proposed planting
B	14/07/2020	Added existing hedgerow heights, amended proposed hedge graphics, altered location of wild bird seed mix.
A	26/10/2020	

**neo**  
**ENVIRONMENTAL**

Nass Office: T:00353 (0)45 844250 E: info@neo-environmental.ie  
Glasgow Office: T: 0141 773 6262 E: info@neo-environmental.co.uk  
Warwickshire Office: T:01768 297012 E: info@neo-environmental.co.uk  
Ballymena Office: T:02890517092 E: info@neo-environmental.co.uk

**Project:** Ballyteige Solar Farm  
**Client:** RES  
**Drawing:** Landscape & Ecology Management Plan  
**Project No.:** NEO00687 **Figure 1.11f**  
**Drawing No.:** NEO00687\_032\_B  
**Drawn:** GC/DW/TL **Checked:** KB **Approved:** PN  
**Scale:** 1:1000 @ A1 **Revision:**  
**Date:** 28th January 2026 **H**